

Adapter-Plates ISAP-K2

Standard dimensions 200 × 200 mm, hole matrix spacing 75 mm

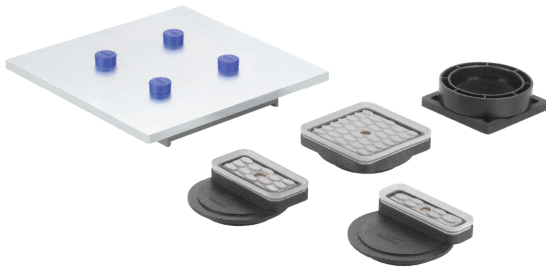

Adapter-Plates ISAP-K2

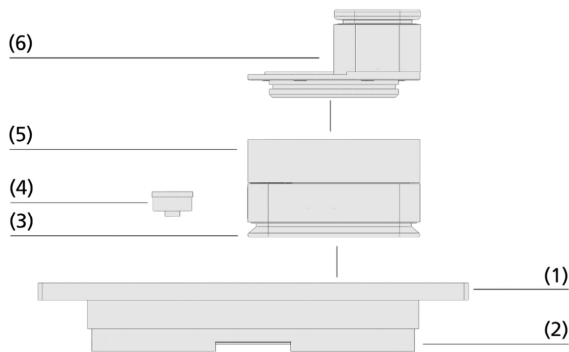

System design Adapter-Plates ISAP-K2

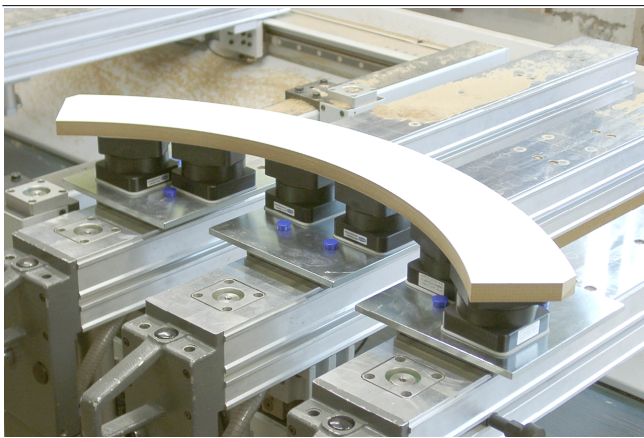

Adapter-Plates ISAP-K2 with Mono-Bases and suction cups for clamping wooden components

Suitability for industry specific applications

Application

- Hose-free vacuum clamping system for CNC machining centers with console table (2-circuit system)
- The Adapter-Plates are positioned directly over the vacuum supply on the consoles
- The Adapter-Plates can be flexibly equipped with up to four additional Mono-Bases and suction cups
- Particularly suitable for narrow and curved workpieces with small suction surfaces and delicate molds
- The modular concept with connectible spacer rings enables various working heights
- Non-damaging and precise clamping with maximum holding force

Design

- Adapter-Plate (1) base plate
- Interface to the machine table (2)
- Mono-Base (3) for positioning on the top of the vacuum openings of the Adapter-Plate and suction cup (6) for fixing the workpiece are available as accessories
- Spacer ring (5) for adjusting the height to the machining height of the machine
- Sealing magnet (4)

Product highlights

- Ideal for narrow and curved workpieces, as plates and vacuum blocks can be flexibly combined
- Freely positionable suction cups and Mono-Bases allow almost any clamping layout
- Mixed operation with standard vacuum blocks possible for even more flexibility and short set-up times
- Accessories and spare parts can be replaced quickly, easily and cost-effectively without tools

Adapter-Plates ISAP-K2

Standard dimensions 200 × 200 mm, hole matrix spacing 75 mm

Designation code Adapter-Plates ISAP-K2

ISAP-K2	–	200x200x26
1		2

1 – Abbreviated designation

Code	Type
ISAP-K2	Innospann adapter plate, 2-circuit console system

2 – Dimensions

Code	LxWxH in mm
200x200x26...	200x200x26 and 200x200x28
200x200x28	200x200x28

The Adapter-Plate ISAP-K2 is delivered assembled. The product consists of:

- Base plate made of steel
- Sealing magnets for closing the vacuum openings

Available spare parts: sealing magnet

Available accessories: Mono-Base, spacer ring, suction cup

Ordering data Adapter-Plates ISAP-K2

Type	Part no.
ISAP-K2 200x200x26	10.01.14.00117
ISAP-K2 200x200x28	10.01.14.00029 







Ordering data Spare parts Adapter-Plates ISAP-K2

Type	Part no.
Sealing magnet ISMST 19-7 4ISMST	10.01.14.00847 

Ordering data Accessories Adapter-Plates ISAP-K2

Type	Part no.
Mono-Base ISMB 80x80x8	10.01.15.00188 
Mono-Base ISMB 80x80x42	10.01.15.00078 

Type	Part no.
Spacer ring, Innospann ISZR-V 80x25	10.01.15.00295
Spacer ring, Innospann ISZR-V 80x45	10.01.15.00054

Type	Part no.
Cup ISCUP Cup 1 80x80x30	10.01.15.00003 
Cup ISCUP Cup 2 80x40x30	10.01.15.00004 
Cup ISCUP Cup 3 80x28x30	10.01.15.00005 
Cup ISCUP Cup 1 80x80x16	10.01.15.00209 
Cup ISCUP Cup 2 80x40x16	10.01.15.00210 
Cup ISCUP Cup 3 80x28x16	10.01.15.00211 

Adapter-Plates ISAP-K2

Standard dimensions 200 × 200 mm, hole matrix spacing 75 mm

Design data Adapter-Plates ISAP-K2

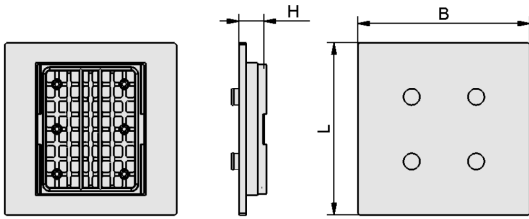

ISAP-K2

Adapter-Plates ISAP-K2

Standard dimensions 200 × 200 mm, hole matrix spacing 75 mm

Design data Adapter-Plates ISAP-K2

Type	B [mm]	H [mm]	L [mm]
ISAP-K2 200x200x26	200	26	200
ISAP-K2 200x200x28	200	28	200

Multimedia product presentation

Medium	Link
Product video	https://vimeo.com/764181610